

**CROSMAN
PLINK-@-MATIC
BB PISTOL**

Mechanism type: Semi-Automatic, CO₂ actuated blow back.

Weight: 2 lbs. 10 ozs. with one loaded Powerlet.

Overall Length: 9 $\frac{5}{8}$ "

Overall Height: 6"

Magazine Capacity: 15 Shots

Sights: Fully adjustable open rear sight, windage moves $\frac{7}{32}$ " per click at 25 feet; elevation moves $\frac{3}{16}$ " per click at 25 feet. Under cut ramp front sight $\frac{1}{10}$ " wide.

Barrel Length: 5 $\frac{1}{16}$ "

Trigger Squeeze: 3-4 pounds

Power Source: One Crosman 12.3 gram Powerlet, 900 P.S.I. at 72°. No appreciable velocity loss between shots of rapid fire string.

Number Shots
per Powerlet: Up to 40

Muzzle Velocity: 340 f/p/s at 72°

Muzzle Energy: 2 foot pounds



The Finest
"POWER WITHOUT POWDER"
Pellet Guns Made

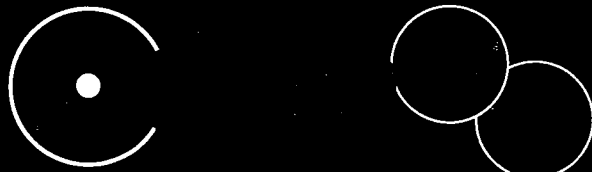

CROSMAN ARMS CO., INC., FAIRPORT, N. Y.

WORLD'S LARGEST MANUFACTURERS OF CO₂ GAS-POWERED RIFLES AND PISTOLS

Model 677 Series CO₂ BB Semi-Automatic Pistol Operating Instructions

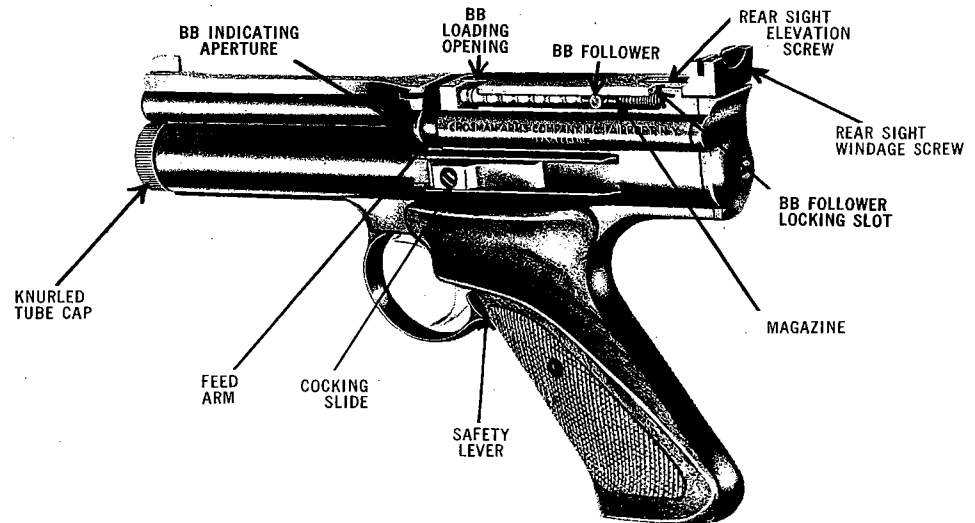

IMPORTANT: Read all instructions carefully, before operating your gun. It is not advisable to fire gun when not under gas pressure as it is harmful to Valve System.

The Model 677 will automatically reload and recock itself for its next firing each time the trigger is pulled, and should be treated as a loaded gun.

It is a 15-shot semi-automatic repeating BB Pistol. It will feed, shoot and cock automatically each time the trigger is pulled, until all the BB's and/or CO₂ gas is exhausted.

The magazine has a capacity of 15 BB's and one will feed each time the trigger is squeezed.

The Rear Sight is adjustable for both windage and elevation, by means of two click adjusting screws.

For best operating results, this gun should be used at temperatures between 30°F. and 85°F. Should gun exhaust CO₂ at low temperatures, normal performance can be obtained by gradually warming for a short period.

CAUTION: Do not expose gun to excessive heat.

TO CHARGE PISTOL WITH CO₂:

1. Put pistol on SAFE by moving Safety Lever UP.
2. COCK PISTOL MANUALLY BY MOVING SLIDE TO REAR, until sear catches Hammer, return slide to forward position. Slide must be in forward position when charging and firing pistol.
3. Retract BB Follower to rear of pistol and lock in locking slot. Remove BB's from magazine through BB Loading Opening. Make sure all BB's are removed from magazine and Feed Arm. BB in Feed Arm can be seen through "BB Indicating Aperture." Release Safety by lowering Safety Lever, fire pistol to exhaust residual gas. Recocking of pistol may be required to exhaust all the gas.
4. Unscrew and remove Knurled Tube Cap (if unable to turn by hand, DO NOT attempt to remove with pliers or other tools, as this denotes the gun is under pressure. Exhaust residual gas as outlined above). Hold muzzle end down and used Powerlet will drop out. Put gun on Safe by moving lever up. Cock pistol manually, return cocking slide to Front Position.
5. INSERT POWERLET IN TUBE WITH NECK TOWARD OPEN END OF TUBE, replace tube cap and screw firmly in place as far down as it will go. Back off cap rapidly $\frac{1}{8}$ turn by hand only, to pierce Powerlet and release CO₂ gas. Release Safety, pull trigger to determine that Powerlet is properly pierced and gun recocks, when trigger is pulled. Pistol is now ready for loading.

IMPORTANT: Proper oiling of this gun will eliminate most sealing failures. USE SPARINGLY. Excessive oiling is harmful to gun action. Three or four drops is sufficient for each seal or oiling point. Apply every 250 shots or when parts appear dry. Be sure "O" Ring on knurled tube cap is clean and free of foreign matter. Never use penetrating or detergent type oils, as they may be harmful to valve washers and seals. USE CROSMAN PELLGUNOIL® FOR BEST RESULTS.

TO LOAD PISTOL:

1. Put pistol on Safe. Push BB Follower to rear of pistol and lock in locking slot. Insert Crosman Trufllyte BB's in loading opening.
2. Release BB Follower in magazine by moving pin out of offset slot. DO NOT slam Follower forward as it will cause feeding malfunction.

TO SHOOT PISTOL:

1. Make sure pistol is cocked by moving cocking slide to rear of gun. Return slide to Front Position, before firing gun.
2. Lower Safety Lever to firing position. Take aim, squeeze trigger to shoot. The gun will recock and reload automatically and is ready for next shot. The gun will shoot each time the trigger is pulled and as long as there is CO₂ gas in the valve mechanism.

CAUTION: If shooting is stopped before magazine is empty, put gun on Safe, push Safety Lever Up, to prevent accidental firing of gun if trigger is touched.

TO UNLOAD BB FROM BARREL AND PISTOL:

1. Put gun on Safe. Empty BB's from magazine and Feed Arm. (See Item No. 3 under "To Charge Pistol with CO₂.")

If Feed Arm is in down or firing position, insert $\frac{3}{16}$ " Ramrod in muzzle end of barrel and lightly push BB into Feed Arm. Recock pistol with slide and push BB out of Feed Arm into magazine through BB Indicating Aperture.

Remove BB from Magazine.

2. If Feed Arm is in Out or cocked position, remove BB from barrel with $\frac{3}{16}$ " Dia. Ramrod. Push BB out into Feed Arm slot, turn pistol over to drop BB out.
3. Exhaust remaining gas in gun by firing until empty. Cock gun with cocking slide if necessary.

TO ADJUST REAR SIGHT:

1. **WINDAGE:** Turning adjustment screw clockwise moves target group to left. Turning adjustment counter-clockwise, moves group to right. At 25 ft. each click will move group $\frac{1}{32}$ ". Each turn will move group $\frac{1}{8}$ ".
2. **ELEVATION:** Turning adjustment screw clockwise lowers group. At 25 ft. each click will move group $\frac{3}{16}$ ". Each turn will move group $1\frac{5}{8}$ ". Turning adjustment counter-clockwise, raises the group. At 25 ft. each click will move group $\frac{1}{32}$ ". Each turn will move group $\frac{1}{8}$ ".

CARE OF PISTOL:

Lubricate as directed above. Never use penetrating or detergent type oils, as they may be harmful to valve washers and seals. Lubricate tube cap seal "O" ring when replacing Powerlet. DO NOT expose charged gun or Powerlet to excessive heat or cold. It is not necessary to clean the barrel of this pistol, but an occasional light oiling is recommended to prevent rusting. USE CROSMAN PELLGUNOIL® FOR BEST RESULTS.

REPAIR SERVICE:

Refer to the attached Service Station list for service.

Replacement Powerlets in a convenient pocket size pack, Crosman Trufllyte BB's, and Crosman Targets can be obtained at Sporting Goods Dealers everywhere.

Postal regulations prohibit the mailing of pistols by individuals. Refer to a bona fide Crosman Dealer for acceptable methods by which this type of pistol may be shipped or mailed.

CROSMAN ARMS COMPANY, INC.
FAIRPORT, NEW YORK

WARRANTY

The gun model series 677 is guaranteed against defective material and workmanship for a period of ninety (90) days from date of purchase providing that the gun has not been subjected to abuse or misuse. *Warranty is void if gun has been disassembled, abused or misused.*

Fill out reverse side of attached warranty registration certificate at time of purchase, retain the certificate until service is needed. Then send it with gun. **GUARANTEE CERTIFICATE MUST BE PRESENTED TO CROSMAN AUTHORIZED SERVICE STATION TO QUALIFY FOR WARRANTY SERVICE.**

List of Parts and Assemblies:

Part No.	Part Name	Part No.	Part Name
677-1	Frame Assembly	600-52	Feed Arm Screw
600-3	Front Sight	500-53	Grip Screw
600-4	Sear Pin	600-54	Hammer Sear
600-5	Trigger Pin	600-55	Hammer Sear Spring
600-6	Sight Ball	600-56	Pawl
600-7	Cover Pin	600-57	Sear Spring
600-9	Plate	600-58	Sear
600-8	Safety Assembly	600-60	Trigger
600-12	Sight Assembly	600-62	Link
600-13	Rear Sight	600-63	Pawl Spring
600-14	Sight Blade	600-65	Plate Screw
600-16	Blade Screw	600-66	Plate Screw Front
600-17	Sight Screw	600-67	Tube
600-18	Safety Screw	600-69	Guide
600-22	Cross Pin	600-73	Tube Cap Assembly
600-23	Cover	600-74	Slide Spring Guide
600-24	Cover Screw	600-78	Buffer Assembly
600-25	Hammer Assembly	600-79	Trigger Spring
600-29	Ring	166-32	"O" Ring
600-30	Valve Assembly	180-5	Hammer Spring
600-36	Retainer Pin	160-33	Barrel Set Screw
677-37	Barrel	140-89	Lockwasher
600-38	Slide	400-17	Spring
600-39	Slide Screw	150-54	"O" Ring
600-40	Cam	105-39	Ball
677-41	Feed Arm	105-45	Spring
45-36	Magazine Spring	400-11	Feed Arm Set Screw
677-44	Follower	600-80	Sight Pad
677-46	Knob	600-90	Stop
600-46	Knob Screw	600-92	Stop Roller
600-49	Hammer Sear Pin	600-93	Trigger Assembly
677-51	Grip Assembly		

L.H. and R.H.

When ordering parts please designate Model number on your gun.

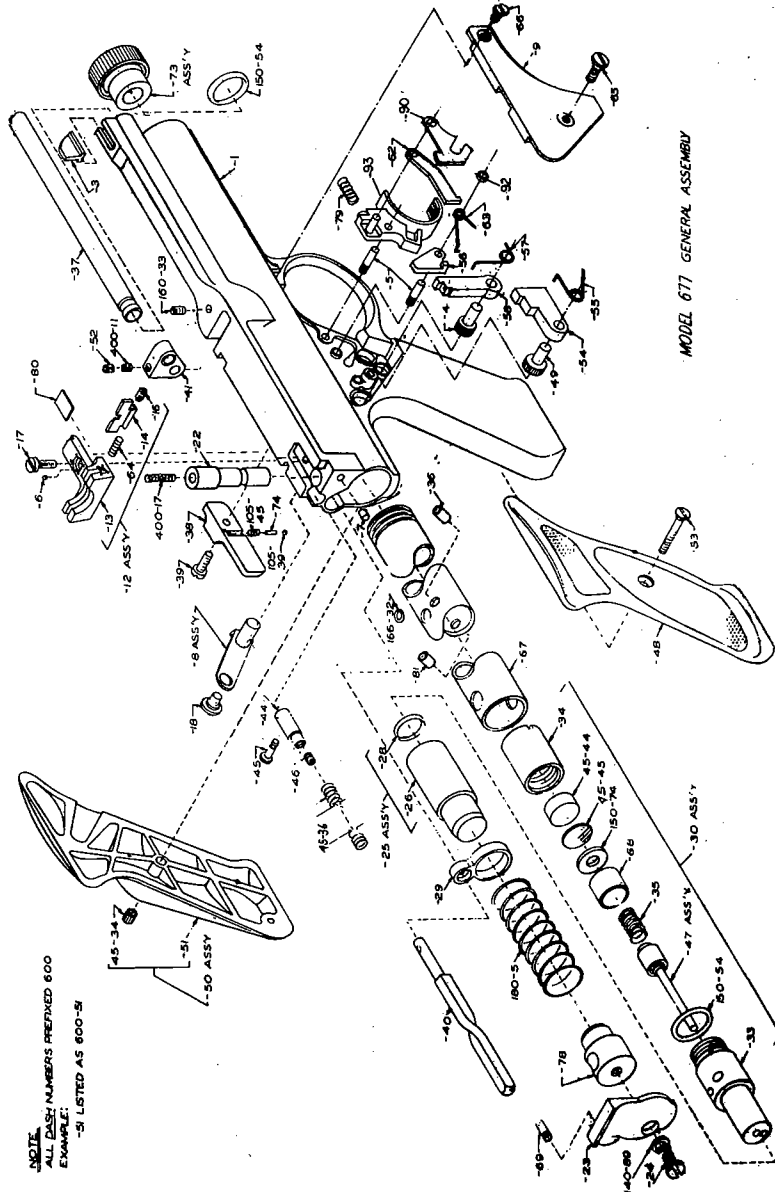

MODEL 677 GENERAL ASSEMBLY